

HOT WATER

RENEWABLES

AIR CONDITIONING

CENTRAL HEATING

SNU | SN

SAVE WATER AND ENERGY WITH A
COMPACT POINT OF USE WATER HEATER.



STIEBEL ELTRON

Technik zum Wohlfühlen

FIVE GOOD REASONS FOR USING A STIEBEL ELTRON SINK HEATER.



Everyone knows they need to save water in these times, the 5 and 10 litre under and over sink hot water systems have been saving water in Germany for over 80 years. Tap sets come complete with the under sink appliances. This energy and water saving water heater is cost effective when considering capital and installation costs.

Installation costs are kept to a minimum with the SN range of heaters. The open vented system does not require a relief valve, thus eliminating the need for overflow pipes. In addition, Australian Standard AS 3500 does not require 5 or 10 litre units to have a plumbed safety tray or relief valve.

1. No safe tray or drain required making the installation a breeze.
2. Water saving is achieved by storing hot water close to the point of use, valuable water is not wasted waiting for the hot water to arrive.
3. Quick and easy electrical connection, all units supplied with a three pin plug and a meter of flex. Enabling the unit to be plugged into a standard power point.
4. Energy saving is achieved with an industry leading standby heat loss, the SNU5 has a standby heat loss of only 0.2 kWh at 65 degrees in 24 hours, massive energy savings.
5. Stiebel Tapware. The choice of tapware that best suits your needs, swivel outlets, with levers or mono-levers, Goose neck spouts and disabled levers.

The cost effective choice.

STIEBEL ELTRON's 'point of use' water heaters are always the cost effective choice. They are easy to install, excellently designed and extremely economical to operate.

The SNU 5 S, for example, only requires .2 kilowatt hours of energy to keep the water in the tank at 65°C for 24 hours – due to its first class CFC-free insulation.

Even where higher quantities of hot water are required more frequently, STIEBEL ELTRON's 'point of use' water heaters are the cost effective choice. An appliance of 10 litres which gives almost 20 litres of mixed water at a pleasant 40°C is ideal to supply a sink.

At a glance.

- 3 year warranty
- Appliance components are fully recyclable.
- High grade CFC free installation.
- Minimum standby power consumption.
- Watermarked to Australian Standards
- Save water
- Quick and simple installations
- Environmentally friendly

A comparison of cold water losses:

'Point of use' water heater pipe length 0.5 metres.



Centralized system pipe length 10 metres.



PLEASE NOTE:
All taps are supplied with flexible connection hoses.



A QUALITY CHOICE: A RANGE OF TAPS FOR POINT OF USE WATER HEATERS.

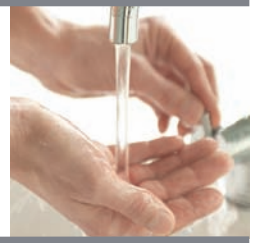

Designed to compliment the brilliant SNU range of water heaters, Stiebel Eltron can now proudly offer the first range of tapware designed specifically for open vented point of use hot water systems. The range includes single lever mixers with swivel outlets and the NEW Mono-lever mixers.



MES
Single lever mixer for sinks with swivel outlet.



MEW
Single lever mixer with swivel outlet.



MES-A
Single lever mixer with swivel outlet.



MES-G
Single lever mixer with swivel outlet.

The NEW SNU 5: Dripstop prevents dripping during heat-up, saves water and reduces limescale build up on tap.

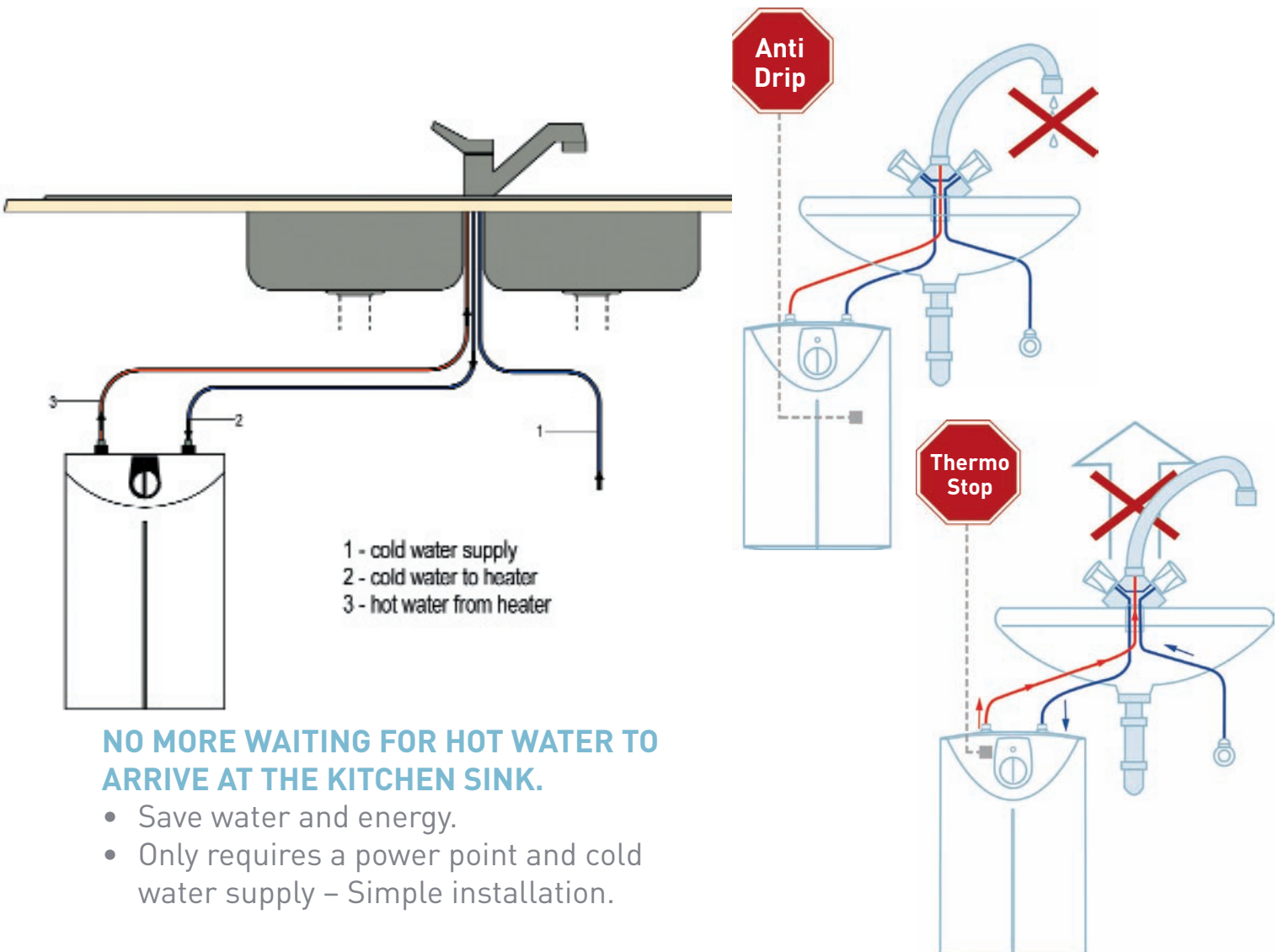

NO MORE WAITING FOR HOT WATER TO ARRIVE AT THE KITCHEN SINK.

- Save water and energy.
- Only requires a power point and cold water supply – Simple installation.

TECHNICAL DATA:

NON - PRESSURISED WATER HEATER (5 OR 10 LITRES) FOR ONE OUTLET.



Type	SNU 5	SNU 10	SN 5	SN 10
Colour	White			
Normal capacity	5	10	5	10
Type of system	non-pressurised (open vented)			
To supply one outlet only	Yes	Yes	Yes	Yes

Dimensions

	mm	421	503	421	503
Height ¹	mm	263	295	263	295
Width	mm	230	275	230	275
Depth	kg	8.1	15	8.1	15
Weight Filled with water	l	10	19	10	19
Volume of mixed water at 40°C ²	kWh	0.2	0.32	0.2	0.32
Standing heat losses at 65°C/24h					

Features

Temperature selected up to	°C	85	85	85	85
Element load		2kW	2kW	2kW	2kW
Electrical connection – 1 metre cord & plug		I/N/PE-240V	I/N/PE-240V	I/N/PE-240V	I/N/PE-240V

Notes:

- 1 With water connection (without fittings)
- 2 The volume of mixed water at 40°C is obtained by adding 15°C cold water to the heater at 65°C

How to specify:

- Determine if you require a 5 or 10 litre unit.
- Determine which tap is required.
- For a 5 litre unit with kitchen mixer tap, specify model SNU 5 with MES-A or MES-G tapware.

Distributed by:

Free Call: 1800 153 351

• Melbourne • Sydney • Brisbane • Perth • Adelaide • Darwin • Tasmania • New Zealand: 0800 200 510

STIEBEL ELTRON

Technik zum Wohlfühlen



WaterMark
AS 3498 Lic W301
Standards Australia

www.stiebel.com.au